

Cable carriers with fixed chain widths

UNIFLEX



UNIFLEX – Cable carriers with fixed chain widths



- Solid plastic
- Can be opened either inwards or outwards (depending on the design)
- Robust, double stroke system for long unsupported lengths
- Particularly high torsional rigidity
- End connectors with integrated strain relief
- Open, half-covered and completely covered designs
- Economically priced standard types
- TÜV design approved in accordance with 2PFG 1036/10.97

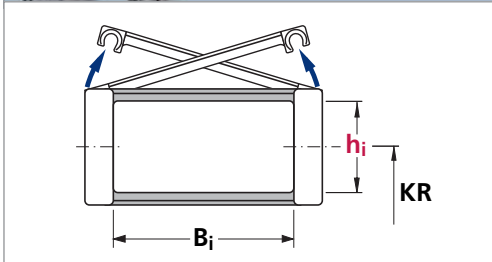

Design 030

Outside: Hinged, openable (on the right/left) and detachable brackets

Dimensions in mm

Type	h_i	B_i	Maximum travel length in m	Dynamics of unsupported arrangement		Page
				Travel speed v_{max} in m/s	Travel acceleration a_{max} in m/s^2	
0250.030	17.5	20-80	60	10	50	50
0345.030	20	15-90	80	10	50	52
0455.030	26	25-130	120	10	50	52
0555.030	38	50-150	125	9	45	52
0665.030	44	50-250	150	8	40	52

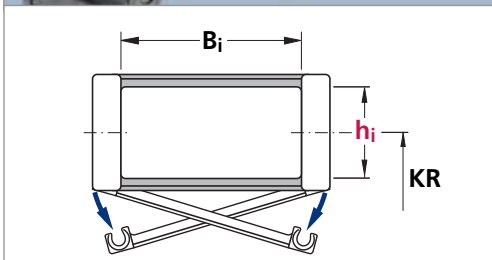

Design 040

Inside: Hinged, openable (on the right/left) and detachable brackets

Dimensions in mm

Type	h_i	B_i	Maximum travel length in m	Dynamics of unsupported arrangement		Page
				Travel speed v_{max} in m/s	Travel acceleration a_{max} in m/s^2	
0345.040	20	15-90	80	10	50	52
0455.040	26	25-130	120	10	50	52
0555.040	38	50-150	125	9	45	52
0665.040	44	50-250	150	8	40	52

UNIFLEX – Cable carriers with fixed chain widths



Design 050

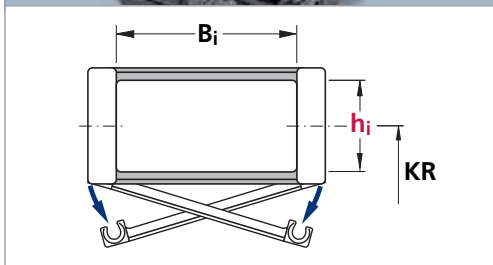

Design 050

Cable carriers covered on one side

Outside: Covered

Inside: Hinged, openable (on the right/left) and detachable brackets Dimensions in mm

Type	h_i	B_i	Maximum travel length in m	Dynamics of unsupported arrangement		Page
				Travel speed v_{max} in m/s	Travel acceleration a_{max} in m/s^2	
0345.050	20	15-65	80	10	50	54
0455.050	26	25-130	120	10	50	54
0555.050	38	50-150	125	9	45	54
0665.050	44	50-175	150	8	40	54



Design 060

Tubes – covered cable carriers

Design 060 with plastic cover system

Outside and inside: Covered

Inside: Hinged, openable (on the right/left) and detachable cover

Detailed information can be found in the chapter Tubes – Covered Cable Carriers from page 134 onwards.

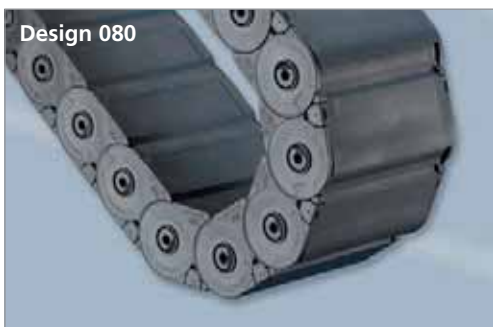

Design 080

Tubes – covered cable carriers

Design 080 – lightweight – with plastic cover system

Outside: Detachable cover

Inside: Covered

Detailed information can be found in the chapter Tubes – Covered Cable Carriers from page 134 onwards.

UNIFLEX – Type 0250

Dimensions and intrinsic chain weight

Type 0250.030

Outside: Hinged, openable and detachable brackets

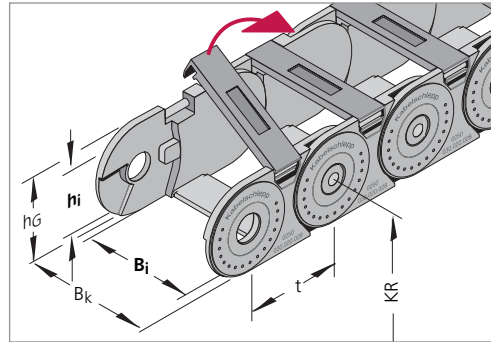

Dimensions in mm/Weights in kg/m

Type	h_i	h_G	Inner widths B_i					B_k	
			Intrinsic chain weight						
0250	17.5	23	20	30	40	50	65	80	$B_i + 10$
			0.26	0.31	0.33	0.35	0.38	0.41	

Bend radius and pitch

Bend radii KR mm					
28	38	45	60	75	100

Pitch $t = 25.0$ mm

Load diagram

for unsupported length L_f depending on the additional load

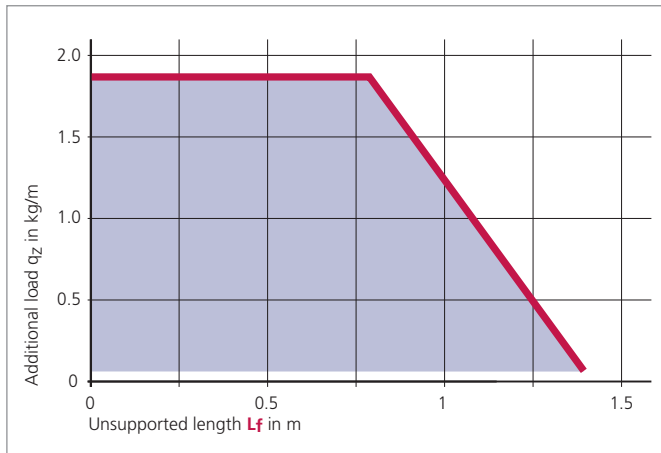

Unsupported length L_f

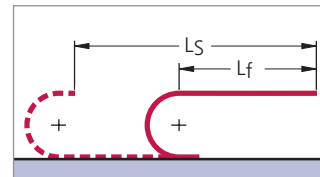

In the case of longer travel lengths, sag of the cable carriers is technically permissible depending on the application.

In a gliding arrangement, even longer travel lengths are possible (see page 219).

We are at your service to advise on these applications.

Divider system

Divider system TS 0

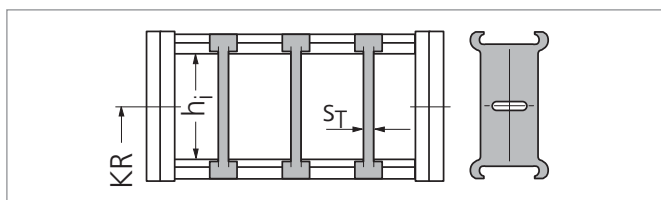

For Type 0250, the divider system TS 1 with a central height subdivision ($S_H = 2,4$ mm) is also available.

Type	h_i mm	S_T mm
0250	17.5	2

In the standard version, the divider systems are mounted on every second chain link.

The dividers can be moved in the cross section.

UNIFLEX – Type 0250

Connection dimensions

Plastic connectors

with integrated strain relief

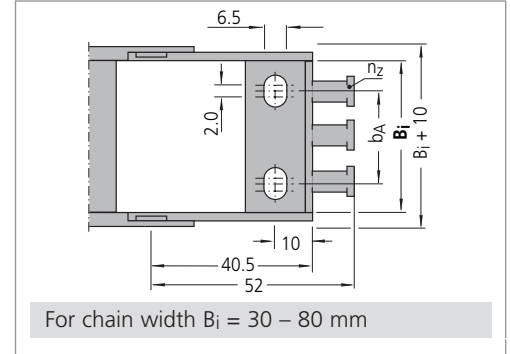
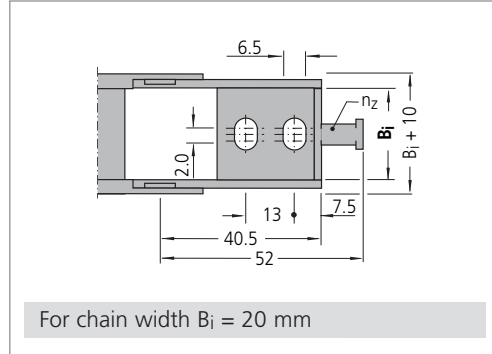
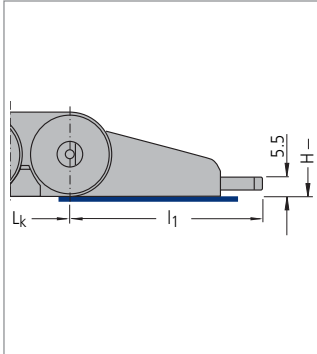

Table of dimensions

Plastic connecting elements with strain relief combs

Dimensions in mm

Type	B_i	B_k	b_A	n_z
0250	20	30	–	1
	30	40	15	2
	40	50	23	3
	50	60	33	4
	65	75	48	5
	80	90	63	6

The dimensions of the fixed point and driver connections are identical.

Connection variants

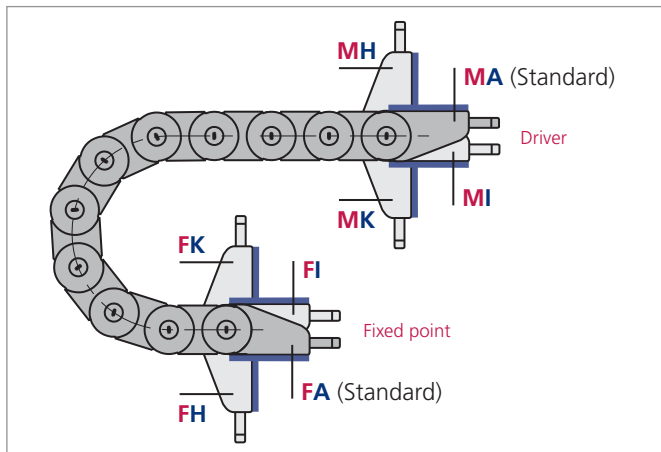

Connection point

- M** – Driver
- F** – Fixed point

Connection type

- A** – Threaded joint outside (standard)
- I** – Threaded joint, inside
- H** – Threaded joint, rotated through 90° to the outside
- K** – Threaded joint, rotated through 90° to the inside

In the standard version, the connectors are mounted with the threaded joint outwards (**FA/MA**).

When ordering please specify the desired connection type (see ordering key on page 243).

The connection type can subsequently be altered simply by varying the connectors.

UNIFLEX – Types 0345, 0455, 0555 and 0665

Dimensions and intrinsic chain weight

Design 030

Outside: Hinged, openable (on the right/left) and detachable brackets

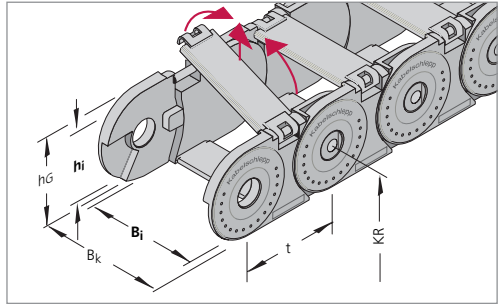

Design 040

Inside: Hinged, openable (on the right/left) and detachable brackets

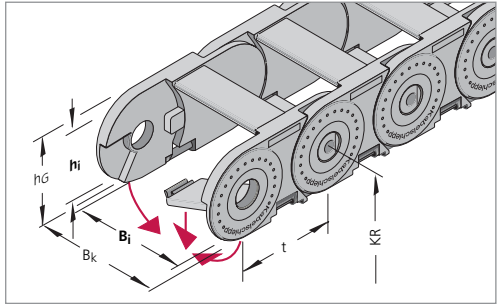

Designs 035 and 045

When hydraulic hoses are being used, with small bend radii, we recommend the use of lockable brackets – Designs .035 and .045.

Designs 030/035 and 040/045

Dimensions in mm/Weights in kg/m

Type	hi	hG	Inner widths Bi								Bk	
			Intrinsic chain weight									
0345	20	28	15	20	25	38	50	65	90	–	–	Bi + 13
			0.43	0.45	0.46	0.50	0.53	0.57	0.71	–	–	
0455	26	36	25	38	58	78	103	130	–	–	–	Bi + 18
			0.81	0.88	0.95	1.02	1.15	1.27	–	–	–	
0555	38	50	50	75	100	125	150	–	–	–	–	Bi + 22
			1.47	1.60	1.72	1.86	1.98	–	–	–	–	
0665	44	60	50	75	100	125	150	175	200	225	250	Bi + 27
			2.06	2.22	2.37	2.53	2.68	2.85	3.00	3.16	3.31	

Bend radius and pitch

Designs 030/035 and 040/045

Dimensions in mm

Type	Bend radii KR							
0345	38	50	75	100	125	150	–	–
0455	52	65	95	125	150	180	200	225
0555	63	80	100	125	160	200	230	–
0665	75	100	120	140	200	250	300	–

Pitch t:

- Type 0345: 34.5 mm
- Type 0455: 45.5 mm
- Type 0555: 55.5 mm
- Type 0665: 66.5 mm

Load diagram

for unsupported length L_f depending on the additional load

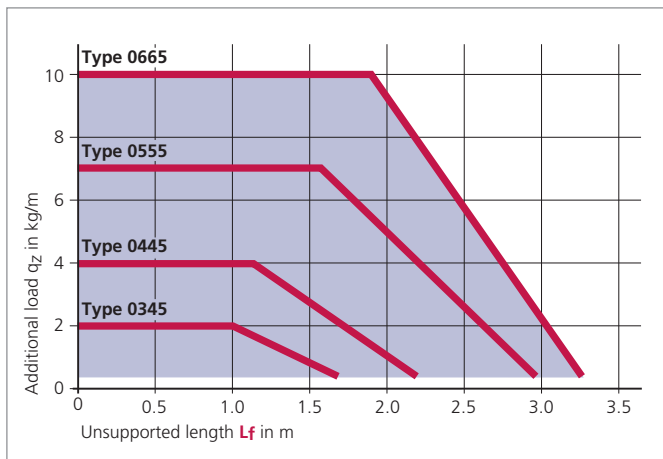

Unsupported length L_f

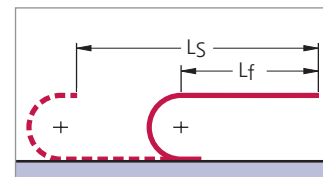

In the case of longer travel lengths, sag of the cable carriers is technically permissible depending on the application.

In a gliding arrangement, even longer travel lengths are possible (see page 219).

We are at your service to advise on these applications.

UNIFLEX – Types 0345, 0455, 0555 and 0665

Divider systems for designs 030 and 040

Divider system TS 0

Type	h_i mm	S_T mm
0345	20	2
0455	26	2.5
0555	38	2.5
0665	44	3

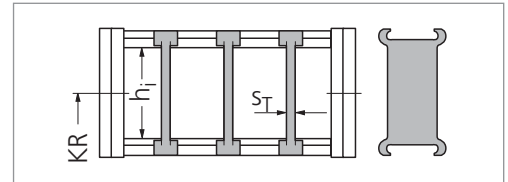

In the standard version, the divider systems are mounted on every second chain link.

The dividers can be moved in the cross section.

Divider system TS 1

with continuous height subdivision made of aluminium

Type	h_i mm	S_T mm	S_H mm	h_1 mm	h_2 mm
0345	20	2	2	10	–
0455	26	2.5	2	10	–
0555	38	2.5	4	14	–
0665	44	3	4	14	28

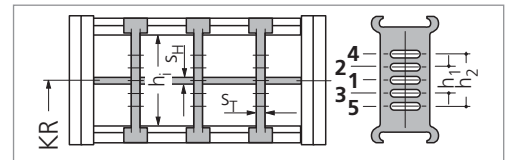

In the standard version, the divider systems are mounted on every second chain link.

The dividers can be moved in the cross section.

Divider system TS 3

with partitioned height subdivision made of plastic

Type	h_i mm	S_T mm	S_H mm	h_1 mm	h_2 mm
0455	26	5	2.4	10	–
0555	38	5	2.4	12	–
0665	44	8	4.0	14	28

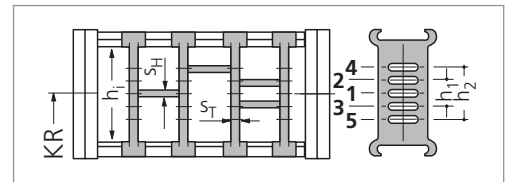

In the standard version, the divider systems are mounted on every second chain link.

The dividers are fixed by the partitions, the complete divider system is movable.

Dimensions of the plastic partitions for TS 3

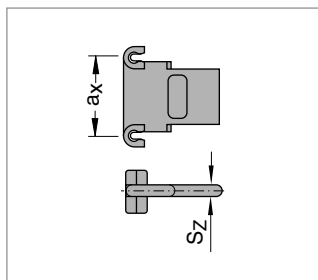

Types 0455 and 0555

Dimensions in mm

S_z	a_x (center-to-center distance, dividers)									
2.4	15	20	25	30	35	40	45	55	65	75

Type 0665

Dimensions in mm

S_z	a_x (center-to-center distance, dividers)									
4	16	18	23	28	32	33	38	43	48	58
	64	68	78	80	88	96	112	128	144	160
	176	192	208							

For type 0665, aluminium partitions in 1 mm width sections are available.

When using **partitions with $a_x > 112$ mm**, there should be an additional central support with a **twin divider** ($S_T = 3$ mm).

Twin dividers are designed for subsequent fitting in the partition system. You can find further information on this in our main catalog.

UNIFLEX – Types 0345, 0455, 0555 and 0665

Dimensions and intrinsic chain weight

Design 050

Cable carriers covered on one side

Outside: Covered

Inside: Hinged, openable (on the right/left) and detachable brackets

Design 055:

When hydraulic hoses are being used, with small bend radii, we recommend the use of lockable brackets – Design 055.

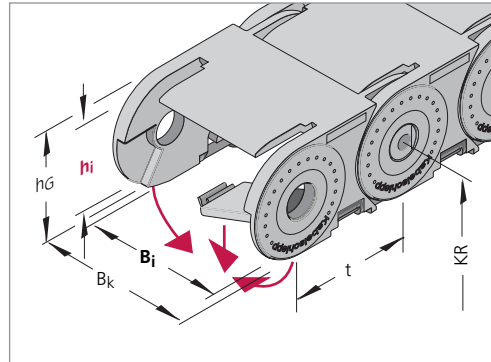

Dimensions in mm/Weights in kg/m

Type	h _i	h _G	Inner widths B _i						B _k
			Intrinsic chain weight						
0345	20	28	15	20	25	38	50	65	B _i + 13
			0.46	0.49	0.52	0.59	0.66	0.75	
0455	26	36	25	38	58	78	103	130	B _i + 18
			0.89	0.97	1.10	1.22	1.40	1.58	
0555	38	50	50	75	100	125	150	–	B _i + 22
			1.64	1.81	1.98	2.16	2.33	–	
0665	44	60	50	75	100	125	150	175	B _i + 27
			2.26	2.53	2.79	3.06	3.33	3.60	

Bend radius and pitch

Dimensions in mm

Type	Bend radii KR							
0345	38	50	75	100	125	150	–	–
0455	52	65	95	125	150	180	200	225
0555	63	80	100	125	160	200	230	–
0665	75	100	120	140	200	250	300	–

Pitch t:

Type 0345: 34.5 mm

Type 0455: 45.5 mm

Type 0555: 55.5 mm

Type 0665: 66.5 mm

UNIFLEX – Types 0345, 0455, 0555 and 0665

Load diagram

for unsupported length L_f depending on the additional load

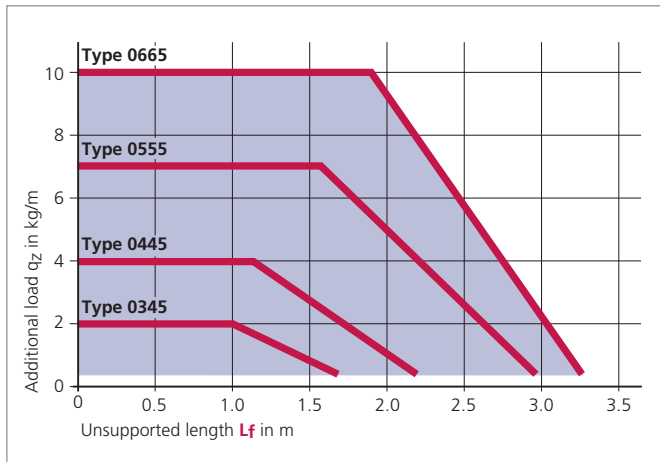

Unsupported length L_f

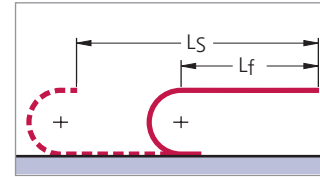

In the case of longer travel lengths, sag of the cable carriers is technically permissible depending on the application.

In a gliding arrangement, even longer travel lengths are possible (see page 219).

We are at your service to advise on these applications.

Divider system for design 050

Divider system TS 0

Type	h_i mm	S_T mm	a_x mm	B_i mm	a_T min mm
0455	26	3	20	25	12.5
0455	26	3	20	38, 58, 78	19
0455	26	3	20	103	21.5
0455	26	3	20	130	25
0555	38	3	25	50 ... 150	25
0665	44	5	25	50 ... 175	25

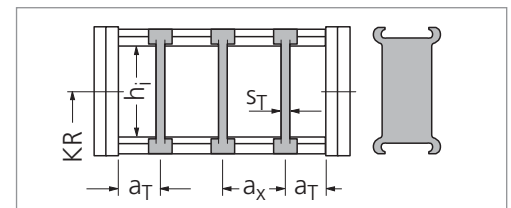

In the standard version, the divider systems are mounted on every second chain link.

The dividers are fixed at an interval of a_x .

For Type 0665, the divider system TS 1 with a central height subdivision ($S_H = 4$ mm) is also available.

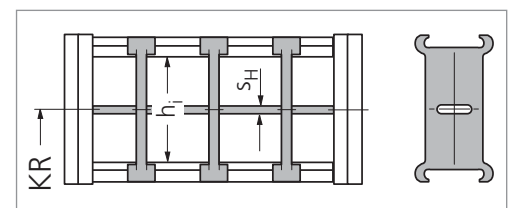

UNIFLEX – Types 0345, 0455, 0555 and 0665

Strain relief devices for plastic connectors

ZLK – A

Connecting elements with integrated strain relief combs on both sides (ZLK – A)



ZLK – L

Connecting elements with screw-on type strain relief combs (ZLK - L)

The strain relief combs are generally supplied with the connecting elements.

The combs are either clipped to the end connectors and bolted together with them, or screwed on at the desired intervals by using additional boreholes, behind the connecting elements.



Connection dimensions for Type 0345

Connecting elements with integrated strain relief combs on both sides

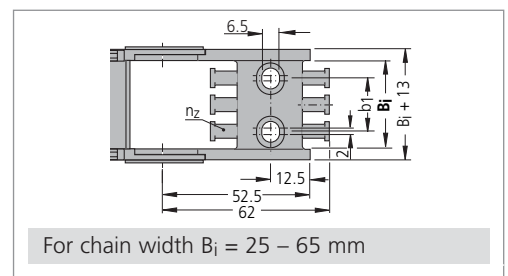
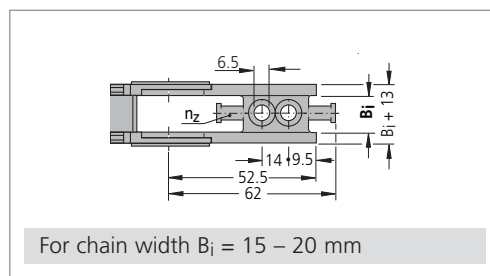
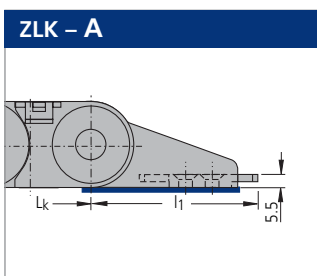

The dimensions of the fixed point and driver connections are identical.

Dimensions in mm

Type	B_i	B_k	b_1	n_z
0345.15	15	28	--	1
0345.20	20	33	--	1
0345.25 *	25	38	13	2
0345.38	38	51	24	3
0345.50	50	63	36	4
0345.65	65	78	51	5

* Type 0345.25 with 6.5 mm hole (not an elongated hole)

UNIFLEX – Types 0345, 0455, 0555 and 0665

Connection dimensions for Type 0455

Connecting elements with strain relief combs on both sides

ZLK – A
integrated strain relief combs

For chain width $B_i = 25$ mm

ZLK – L
screwable strain relief combs

For chain width $B_i = 38 - 130$ mm

The dimensions of the fixed point and driver connections are identical.

Dimensions in mm

Type	B_i	B_k	n_z
0455.25	25	43	2
0455.38	38	56	3
0455.58	58	76	4
0455.78	78	96	6
0455.103	103	121	8
0455.130	130	148	10

Connection dimensions for Type 0555

Connecting elements with strain relief combs on both sides

ZLK – L screwable strain relief combs

The dimensions of the fixed point and driver connections are identical.

Dimensions in mm

Type	B_i	B_k	n_z
0555.50	50	72	2
0555.75	75	97	3
0555.100	100	122	4
0555.125	125	147	6
0555.150	150	172	8

UNIFLEX – Types 0345, 0455, 0555 and 0665

Connection dimensions for Type 0665

Connecting elements with strain relief combs on both sides

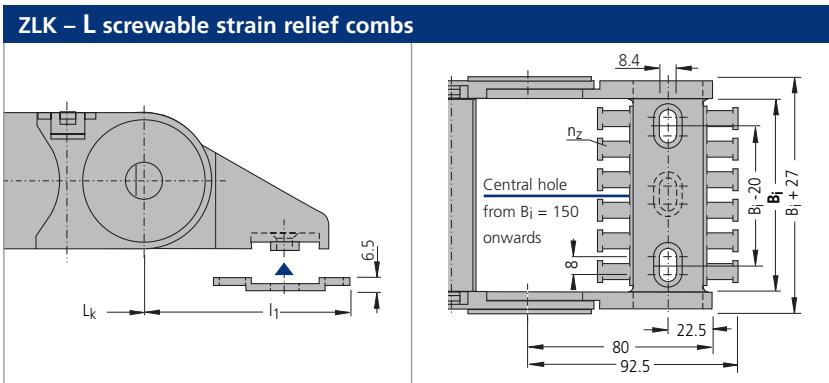

The dimensions of the fixed point and driver connections are identical.

Dimensions in mm

Type	B_i	B_k	n_z
0665.50	50	77	4
0665.75	75	102	6
0665.100	100	127	8
0665.125	125	152	10
0665.150	150	177	12
0665.175	175	202	14
0665.200	200	227	16
0665.225	225	252	18
0665.250	250	277	20

UNIFLEX – Types 0345, 0455, 0555 and 0665

Connection variants

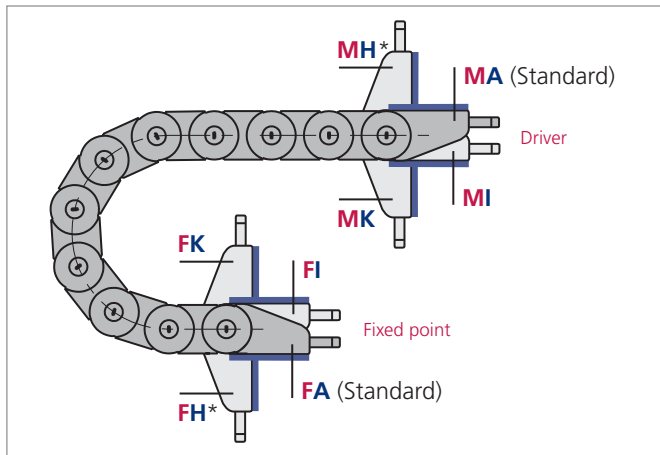

Connection point

- M** – Driver
- F** – Fixed point

Connection type

- A** – Threaded joint outside (standard)
- I** – Threaded joint inside
- H** – Threaded joint, rotated through 90° to the outside
- K** – Threaded joint, rotated through 90° to the inside

In the standard version, the connectors are mounted with the threaded joint outwards (**FA/MA**).

When ordering please specify the desired connection type (see ordering key on page 243).

The connection type can subsequently be altered simply by varying the connectors.

* not in the case of UNIFLEX design 060

UNIFLEX – Types 0345, 0455, 0555 and 0665

Connection dimensions

UMB (Universal Mounting Brackets) made of aluminium

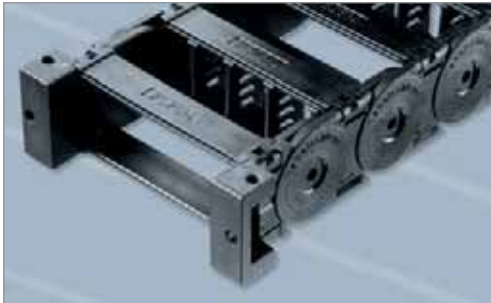

Universal connectors for connection above, below or at the front.

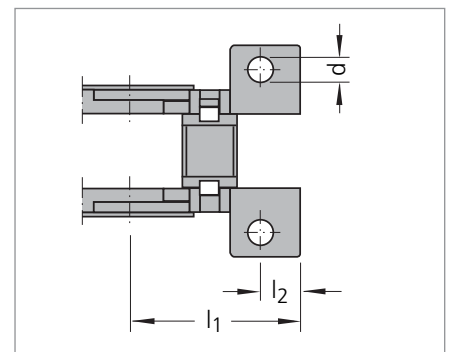
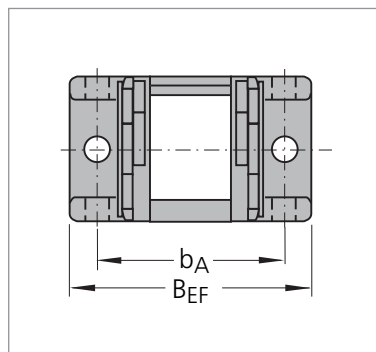
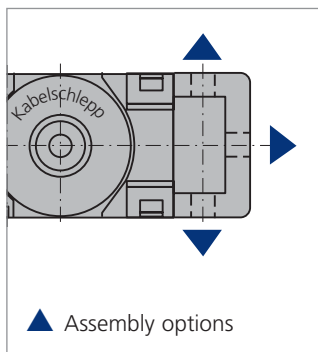

The dimensions of the fixed point and driver connections are identical.

Type	B_{EF}	b_A	l_1	l_2	d
0345	$B_i + 30$	$B_i + 20$	36	9	5.5
0455	$B_i + 30$	$B_i + 20$	47	10.5	5.5
0555	$B_i + 40$	$B_i + 28$	57	13.5	6.5
0665	$B_i + 44$	$B_i + 28$	68	14.5	8.5